

## 9800 & F9800 Rim Type Panic and Fire Exit Devices 9860 & F9860 Vertical Rod Panic and Fire Exit Devices ANSI A156.3, Grade 1



3 HOUR FIRE RATED  
UL10C, UBC7-2-1997



### Features & Construction

- Retrofits Sargent 8800 Series using 9800 Escutcheon Trim
- ANSI A156.3, Grade 1 heavy duty exit device in surface vertical rod and rim designs
- Rail assemblies and end caps are brass, bronze or stainless steel and rail travels in direction of the door swing.
- Trims are thru bolted for additional security.
- Conforms & meets ADA Regulations.
- UL Listed for Panic and UL10C, UBC 7-2-1997 codes.
- UL Listed for Fire Exit Hardware. 3 hours.
- (A) label rating on pairs of doors up to 8'0" x 8'0" swinging in same or opposite directions.
- Uncompromising security and safety in single and double fire exit doors.
- Chassis mounted unit construction. Rim and vertical rod devices are non-handed and easily reversible.
- Available in many different functions. Lever and escutcheon trims are grade 1 construction with clutch on rose trims. Escutcheon trims are rigid and covers 161 cut out.

### Suggested Architect's Specifications

- All exit devices shall be of touch bar design with smooth operation and be operative over  $\frac{2}{3}$  of the door's clear opening width
- All exit devices must be listed under "Panic Hardware" in the Accident Equipment List of Underwriter's Laboratories, Inc. Where labeled doors are used as exits, they must be equipped with labeled Fire Exit Hardware and UL10C, UBC 7-2-1997 codes.
- All springs shall be of stainless steel throughout.
- All exit devices shall be of chassis mounted unit construction.
- All exit devices shall be ANSI A156.3, Grade 1.

### Features & Construction

- For use in institutions, schools, universities, commercial buildings where heavy duty reliable operation is a requirement.

# 9800 & F9800 Series

## Grade 1 Rim Type Exit Device



**MEETS**  
*The Buy American Act*

Lifetime  
Warranty  
**BHMA**  
CERTIFIED



3 HOUR FIRE RATED  
UL10C, UBC7-2-1997

### Specifications

<b>For Doors.....</b>	1 3/4" thick standard optional 2 1/4" thick. 4 1/2" minimum stile width required for single or double door application using standard 239 strike and pull or lever, thumbpiece and escutcheon trims. 2 3/4" backset.
<b>Chassis.....</b>	Nonferrous alloy (Panic Grade), steel (Fire Grade)
<b>Cover.....</b>	Brass, Bronze or Stainless Steel. Covers stock hollow metal doors with 161 cutout.
<b>Mounting.....</b>	Furnished with wood and machine screws. Available with thru bolts on request. <b>Thru bolts are included and standard packaging on fire rated devices.</b>
<b>End Cap.....</b>	Brass, Bronze or Stainless Steel construction.
<b>Alarm.....</b>	Available. See page 33
<b>Hand.....</b>	Non handed, center hub.
<b>Latch Bolt.....</b>	Stainless Steel 3/4" throw.
<b>Spring.....</b>	Stainless Steel throughout.
<b>ANSI Standard.....</b>	A156.3, Grade 1
<b>Strike.....</b>	239 packed standard (See strike page).
<b>Trim.....</b>	See Trim Designs section
<b>Dogging Feature.....</b>	Allen-type key furnished standard on non-fire labeled devices. Cylinder dogging available.
<b>Mullion.....</b>	Available.
<b>UL and ULC Listed.....</b>	9800 Series for panic. F9800 Series for fire exit hardware for all types of 4' x 8' single doors and 8' x 8' double doors for up to 3 hour fire labeled installations, conforms to standards UL10C and UBC 7-2-1997 codes.
<b>Finish.....</b>	Architectural plated finishes. See page 33
<b>Electronic Functions.....</b>	(ELR) Electrical Latch Retraction and RX & LX Signal Switch available

### DIMENSIONS

Touchbar height to finished floor	41" (1043mm) at center
Touchbar Projection	
Neutral	2 1/2" (64mm)
Depressed	1 3/4" (45mm)
Center case	8 1/2" x 2 1/2" x 2" (216mm x 69mm x 52mm)

MODEL	ACTUAL SIZE	MAX CUT DOWN	DOOR SIZE
9800EO24, F9800EO24	20"	2"	22" to 24" door width
9800EO32, F9800EO32	28"	6"	26" to 32" door width
9800EO36, F9800EO36	32"	6"	30" to 36" door width
9800EO48, F9800EO48	44"	12"	36" to 48" door width

### Minimum stile requirements

4" escutcheon trims and 4 1/2" for thumbpiece and rose trims

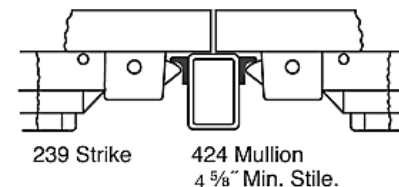
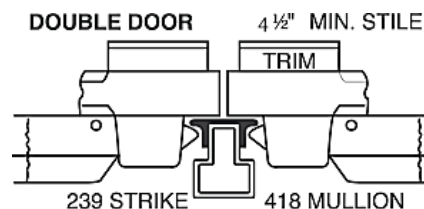

### SINGLE DOOR 4 1/2" MIN. STILE

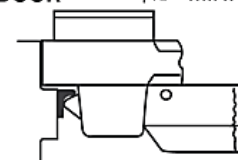

# 9860 & F9860 Series

## Grade 1 Vertical Rod Type Exit Device



### Specifications

<b>For Doors.....</b>	1 ¾" thick standard optional 2 ¼" thick. 3 ¾" minimum stile width required for single door application. 3 ½" minimum stile width required for double door application. Lever, thumbpiece and escutcheon trims available. 2 ¾" backset.
<b>Chassis.....</b>	Nonferrous alloy (Panic Grade), steel (Fire Grade)
<b>Cover.....</b>	Brass, Bronze or Stainless Steel. Covers stock hollow metal doors with 161 cutout.
<b>Mounting.....</b>	Furnished with wood and machine screws. <b>Thru bolts are standard packaging on fire rated devices.</b>
<b>Alarm.....</b>	Available. Prefix "NALRM" before part #
<b>End Cap.....</b>	Brass, bronze or stainless Steel Construction.
<b>Hand.....</b>	Handed. Easily field reversible. Specify at time of order LHR, RHR for convenience.
<b>Latch Bolt, Spring.....</b>	Stainless Steel
<b>ANSI Standard.....</b>	A156.3, Grade 1
<b>Rail Assembly.....</b>	Heavy gauge brass, bronze or stainless steel
<b>Strike.....</b>	See strike page
<b>Dogging Feature.....</b>	Allen-type key furnished standard on non-fire labeled devices. Cylinder dogging available
<b>Electronic Functions.....</b>	(ELR) Electrical Latch Retraction and RX & LX Signal Switch available
<b>UL and ULC Listed.....</b>	9860 Series for panic. F9860 Series for fire exit hardware for all types of 8' x 8' double doors for up to 3 hour fire labeled installations, conforms to standards UL10C and UBC 7-2-1997 codes
<b>Finish.....</b>	Architectural plated finishes. See page 33



### DIMENSIONS

Touchbar height to finish floor	41" (1034mm) at center
Touchbar Projection	
Neutral	2 ½" (64mm)
Depressed	1 ¾" (45mm)
Panic grade top & bottom latch case	3-15/16" x 2 1/8" x 1 3/8" (100mm x 52mm x 42mm)
Fire grade top latch case	3-15/16" x 2-11/16" x 2-1/16" (100mm x 68mm x 53mm)
Fire grade bottom latch case	3-15/16" x 2 1/8" x 1 3/8" (100mm x 52mm x 42mm)
Top and bottom rod length for 36" x 84"	Top rod 37 ½" (955mm), bottom rod 84" (2134mm)
Top and bottom rod length for 48" x 96"	Top rod 49-5/8" (1260mm), bottom rod 96" (2438mm)
Vertical rods	½" (13mm) Round tubing

MODEL	ACTUAL LENGTH	MAXIMUM CUT DOWN	DOOR SIZE
9860V3684, F9860V3684, 9890V3696, F9890V3696 and 9850V36120	32"	6"	30" to 36" door width
9880V4896, F9880V4896 and 9840V48120	44"	12"	36" to 48" door width

**Minimum Stile Requirements**  
Double Door-Width Two Vertical Rod Type Exit Devices

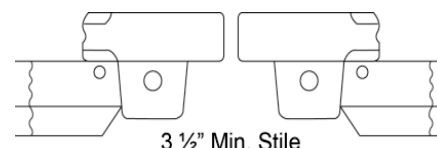

# LBR9860 & LBRF9860 Series



## Grade 1 Vertical Rod Type Exit Device Less Bottom Rod (LBR)

### Specifications

<b>LBR</b> .....	No Bottom Strike. Free access for wheel chairs, stretcher and carts therefore eliminates tripping potential and disfiguration of floors due to dragging of bottom bolts.
<b>For Doors</b> .....	1 3/4" thick standard. 3 3/4" minimum stile width required for single door application. 3 1/2" minimum stile width required for double door application. Lever, thumbpiece and escutcheon trims available. 2 3/4" backset.
<b>Chassis</b> .....	Nonferrous alloy (Panic Grade), steel (Fire Grade)
<b>Cover</b> .....	Brass, Bronze or Stainless Steel. Covers stock hollow metal doors with 161 cutout
<b>Mounting</b> .....	Furnished standard with wood and machine screws. <b>Thru bolts are standard packaging on fire rated devices.</b>
<b>Alarm</b> .....	Available. Prefix "NALRM" before part #
<b>End Cap</b> .....	Brass, Bronze or Stainless Steel construction
<b>Hand</b> .....	Handed. Easily field reversible. Specify at time of order LHR, RHR for convenience
<b>Latch Bolt, Spring</b> .....	Stainless Steel
<b>Auxiliary Spring Latch</b> .....	Auxiliary spring loaded latchbolt is installed in the lower edge of the door, when exposed to fire latchbolt releases keeping the door closed and regulated.
<b>ANSI Standard</b> .....	A156.3, Grade 1
<b>Rail Assembly</b> .....	Heavy gauge brass, bronze or stainless steel
<b>Strike</b> .....	See strike page
<b>Dogging Feature</b> .....	Allen-type key furnished standard on non-fire labeled devices. Cylinder dogging available
<b>Electronic Functions</b> .....	(ELR) Electrical Latch Retraction and RX & LX Signal Switch available
<b>UL and ULC Listed</b> .....	All Series for panic. <b>LBR Series</b> for fire exit hardware for all types of 8' x 8' double doors including double egress for up to 3 hour metal, 1 1/2 hour wood doors fire labeled installations. Conforms to standards UL10C and UBC 7-2-1997 codes.
<b>Finish</b> .....	Architectural plated finishes. See page 33



### DIMENSIONS

Touchbar height to finish floor	41" (1034mm) at center
Touchbar Projection	
Neutral	2 1/2" (64mm)
Depressed	1 3/4" (45mm)
Panic grade top & bottom latch case	3-15/16" x 2 1/8" x 1 3/8" (100mm x 52mm x 42mm)
Fire grade top latch case	3-15/16" x 2-11/16" x 2-1/16" (100mm x 68mm x 53mm)
Fire grade bottom latch case	3-15/16" x 2 1/8" x 1 3/8" (100mm x 52mm x 42mm)
Top and bottom rod length for 36" x 48"	Top rod 37 1/2" (955mm), bottom rod 84" (2134mm)
Top and bottom rod length for 48" x 96"	Top rod 49-5/8" (1260mm), bottom rod 96" (2438mm)
Vertical rods	1/2" (13mm) Round tubing



Aux Fire Latch Assembly

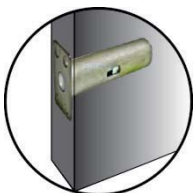

MODEL	ACT LENGTH	MAX CUTDOWN	DOOR SIZE
LBR9860V3684, LBRF9860V3684, LBR9890V3696, LBRF9890V3696	32"	6"	30" to 36" door width
LBR9880V4896, LBRF9880V4896	44"	12"	36" to 48" door width

**Minimum Stile Requirements**  
Double Door-Width Two Vertical Rod Type Exit Devices

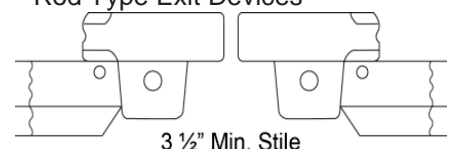



# Alarm Exit Hardware



3 HOUR FIRE RATED  
UL10C, UBC7-2-1997

## Rim Type Exit Devices

NALRM9800EO36	Alarm Rim Type 36" Door (Panic Grade)
NALRM9800EO48	Alarm Rim Type 48" Door (Panic Grade)
FNALRM9800EO36	Alarm Rim Type 36" Door (Fire Grade)
FNALRM9800EO48	Alarm Rim Type 48" Door (Fire Grade)

## Vertical Rod Type Exit Devices

Prefix "NALRM" before PART#

## Features

- 1-, 3-, 5-minute and continuous alarm type settings available
- ON and OFF power switch
- Alarm sound frequency is 120 db
- Alarm unit has an internal horn. When the push rail is depressed, the horn sounds to provide an audible means of signaling that the door has been opened and breached
- The key switch to turn alarm off is a standard 1 ¼" cylinder with "C" keyway. The alarm operates on one standard 9 volt transistor battery. When battery is weak the horn will emit an intermittent signal.
- Alarmed units are supplied with a micro switch, which monitors the push rail and the latch bolt for foolproof security on rim devices
- Alarm unit has a signal OC output that can be linked to external alarm control systems
- Easy removal of the alarm unit without the need to dismount the exit device for battery maintenance
- Unit includes **"EMERGENCY EXIT ONLY • ALARM WILL SOUND"** decal for application on door or unit

## Finishes (Refer to Price List for Stock Finishes)

Cal-Royal	Description	BHMA	US Finish	Material
P	Prime Coat	600	USP	Steel
3	Polished Brass, Clear Powder Coat	605	US3	Brass
4	Satin Brass, Clear Powder Coat	606	US4	Brass
9	Polished Bright Bronze	611	US9	Bronze
10	Satin Bronze, Clear Powder Coat	612	US10	Bronze
10B	Oil Rubbed Bronze	613	US10B	Bronze
26	Polished Bright Chrome	625	US26	Brass
26D	Satin Chrome	626	US26D	Brass
32	Polished Bright Stainless	628	US32	Stainless Steel
32D	Satin Stainless	630	US32D	Stainless Steel

# Trim Selection

## LEVER DESIGN

### Non-handed Grade 1 (Clutch Style)

Cylindrical body hardened steel heavy duty tailpiece. For 1 3/4" and 2 1/4" doors. Prefix THI before part # for 2 1/4" door thickness. Available for fire and non fire rated rim and vertical rod exit devices.

Rose diameter 3 1/2", lever length 4 3/4". Fits and covers 161 cutout.

Finishes: Architectural plated finishes.

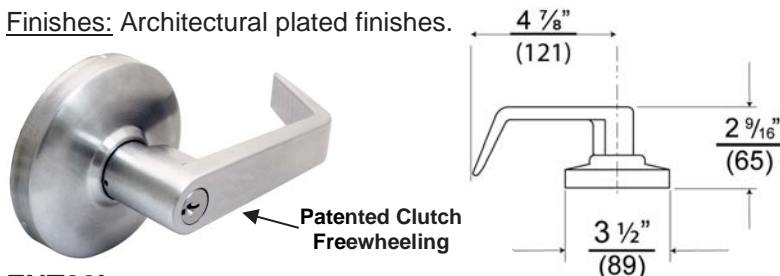

ENT00L or

ICENT00L or

ICSCENT00L4

SARICENT00L (Sargent)

RUSICENT00L (Corbin/Russwin)

YALICENT00L (Yale)

8000K

### ENTRANCE

Key locks and unlocks lever.

Operates as CLASSROOM FUNCTION.

ANSI Function – 08

Ball Knob Keylock

### STOREROOM

Key operates lever, otherwise always locked.

ANSI Function – 04

STR05L or

ICSTR05L or

ICSCSTR05L4

SARICSTR05L (Sargent)

RUSICSTR05L (Corbin/Russwin)

YALICSTR05L (Yale)

PAS30L

### PASSAGE

Trim always operable and free.

ANSI Function - 15

DUM40L

### DUMMY

Dummy trim. One sided

ANSI Function – 10

When ordering "AT" and "SPA" designs, prefix design name before part #. Example: ENT00L in "AT" is **ATENT00L**.

**KEYWAY:** 6 pin solid brass "C" keyway standard. Optional: Schlage E, Schlage C-K, Russwin D1-2-3-4, Corbin 59/60, Sargent LA-LB-LC, Falcon/Weiser E, Arrow A, Yale 8, Yale GA and Kwikset. Can also accept Medeco, Assa and Kaba High Security Cylinders.

### (IC) INTERCHANGEABLE CORE

Interchangeable Core locks will accept compatible 6 or 7 pin cores with BEST, FALCON and ARROW.

### (ICSC) INTERCHANGEABLE CORE: Indicates function available with Schlage Full size format Interchangeable Core.

## Other Lever Trim Designs



TUB DESIGN

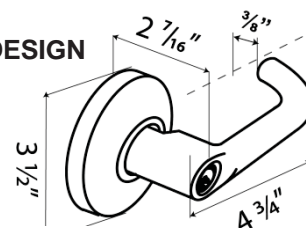

AT DESIGN

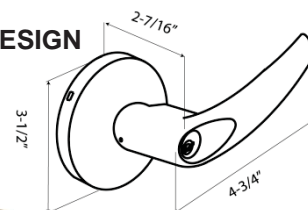

SPA DESIGN

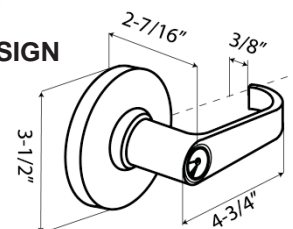

8000K

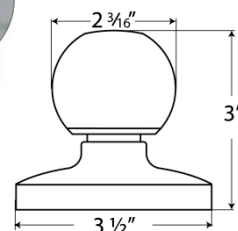

# Trim Selection

## ESCUTCHEON LEVER DESIGN

### CONSTRUCTION

- Rigid, non clutch mechanism.
- Double heavy duty spring support to prevent sagging and enhance operation.
- Grade 1, thru-bolted design. Non-handed design. Easily field reversible.
- Hardened steel heavy duty tailpiece. Available for fire and non fire rated rim and vertical rod exit devices.

### DOOR THICKNESS

Standard 1  $\frac{3}{4}$ ". For 2  $\frac{1}{4}$ " thick door use additional part# TAIL3.

### ESCUTCHEON DIMENSIONS

2  $\frac{3}{4}$ " width X 10  $\frac{1}{4}$ " length. Lever length: 4  $\frac{3}{4}$ "  
Fits and covers 2  $\frac{1}{8}$ " 161 cutout

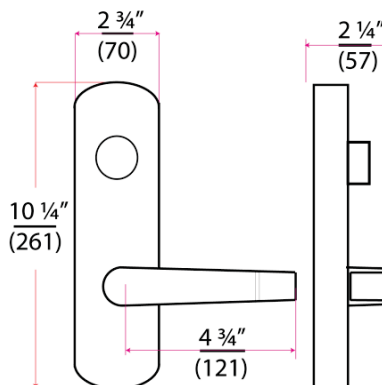

**NESC9800 or**  
**ICNESC9800 or**  
**ICSCNESC9800**

### ENTRANCE

Rigid Entrance, key locks or unlocks escutcheon trim  
ANSI FUNCTION (63) Operates as classroom function

**NESC9805 or**  
**ICNESC9805 or**  
**ICSCNESC9805**

### STOREROOM

Rigid Storeroom, key unlocks lever, lever retracts latch bolt, otherwise always locked  
ANSI FUNCTION (04)

**NESC9830**

### PASSAGE

Trim always operable and free  
ANSI FUNCTION (62)

**NESC9840**

### DUMMY

Dummy Escutcheon trim ANSI FUNCTION (10)

**TO ORDER** other lever design replace "N" with "AT" or "RL" :  
e.g. **ATESC9800** for ESC9800 with AT design or **RLESC9800** for ESC9800

**KEYWAY:** 6 pin solid brass "C" keyway Mortise Cylinder standard. Optional: Schlage E, Schlage C-K, Russwin D1-2-3-4, Corbin 59/60, Sargent LA-LB-LC, Falcon/Weiser E, Arrow A, Yale 8, Yale GA and Kwikset. Can also accept Medeco, Assa and Kaba High Security Cylinders.

**FOR ELECTRIFIED TRIM OPTIONS SEE PAGE 37**

**(IC) INTERCHANGEABLE CORE:** Interchangeable Core locks will accept compatible 6 or 7 pin cores with BEST, FALCON and ARROW.

**(ICSC) INTERCHANGEABLE CORE:** Indicates function available with Schlage Full size format Interchangeable Core.

### Lever Trim Designs



**NESC**



**ATESC**



**RLESC**

# Trim Selection

## PULL DESIGN

**9800 NL**  
 **IC9800NL**  
 **ICSC9800NL**

### FOR RIM DEVICES ONLY

Outside by pull and key.

Key retracts latch bolt.

ANSI function – 03

Covers 161 cutout

### KEYWAY

6 pin solid brass “C” keyway

Rim Cylinder standard.

### FINISHES

Architectural plated finishes.



**9800 DTP**

Outside by pull only.

Pull when dogged.

ANSI function – 02

Covers 161 cutout



**9800 EOP**

Outside by plate only.

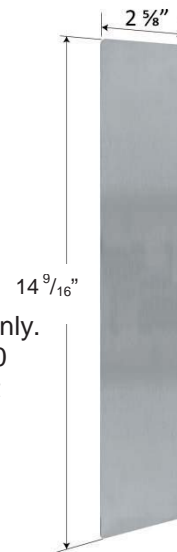

ANSI function – 10

Covers 161 cutout



## THUMBPIECE TRIM

(OPERATES ON RIM & VERTICAL ROD DEVICES)



**98TP00 or**  
 **IC98TP00**  
 **ICSC98TP00**

### ENTRANCE

Key locks or unlocks thumbpiece.

(Operates as classroom function)

ANSI Function – 63

**98TP05 or**  
 **IC98TP05**  
 **ICSC98TP05**

### STOREROOM

Key unlocks thumbpiece, thumbpiece

retracts latch bolt, otherwise always

lock. ANSI Function-04

**98TP30**

### PASSAGE

Trim always operable and free.

ANSI Function – 63

**98TP40**

### DUMMY

Dummy trim. **Includes blank Mortise dummy cylinder.** One sided.

ANSI function – 10



**KEYWAY:** 6 pin solid brass “C” keyway Mortise Cylinder standard. Optional: Schlage E, Schlage C-K, Russwin D1-2-3-4, Corbin 59/60, Sargent LA-LB-LC, Falcon/Weiser E, Arrow A, Yale 8, Yale GA and Kwikset. Can also accept Medeco, Assa and Kaba High Security Cylinders.

## (IC) INTERCHANGEABLE CORE

Interchangeable Core locks will accept compatible 6 or 7 pin cores with BEST, FALCON and ARROW.

## (ICSC) INTERCHANGEABLE CORE: Indicates function available with Schlage Full size format Interchangeable Core.



# Electrified Lever Trim



Cal-Royal's electrified lever trim provides remote locking and unlocking capabilities while incorporating the patented clutch trim design. The 24V DC solenoid can be energized from a distant controller, thus allowing access control of the opening.

The control of stairwells in high-rise buildings is a common application for this trim, where electric pullback of the exit device's latch bolt is cost prohibitive or not required. This is especially practical in applications where fire/life safety codes require a "fail-safe" condition which is not an option with electrified latch pullback devices. Because the current draw is quite low there is no need for a more expensive power supply to provide the surge current.

## Features

- Continuous duty solenoids used to insure trouble-free operation
- Internally mounted solenoid to ease installation (no special door prep required)
- No hassle 3-Year Warranty

## Options

- Available Fail Safe (electrically locked) or Fail Secure (Electrically Unlocked)
- Voltage options – 12V or 24V (AC/DC)
- Request to Enter Switch (REE) available
- CRU2 – Current Reduction Unit to improve solenoid life in "continuously on" applications

## Specifications

Solenoid.....Continuous Duty 24VDC

Operating Voltage....12 or 24VAC/DC + OR – 10% (must specify 12 or 24 volts when ordering)

Amperage.....260mA@12V / 160mA@24V

Coil Resistance.....12V=49Ω / 24V=159Ω

## To order, Specify:

OPTIONS: FAIL SAFE (FS)  
FAIL SECURE (FSE)

ITEM#	DESCRIPTION
FS12 NESC98	<b>FS12</b> FAIL-SAFE OPTION 12V AC/DC
FS24 NESC98	<b>FS24</b> FAIL-SAFE OPTION 24V AC/DC
FSE12 NESC98	<b>FSE12</b> FAIL-SECURE OPTION 12V AC/DC
FSE24 NESC98	<b>FSE24</b> FAIL-SECURE OPTION 24V AC/DC

**TO ORDER** other lever design replace "N" with "AT" or "RL" :  
e.g. **ATESC98** for ESC98 with AT design or **RLESC98** for ESC98 with RL design

## Lever Trim Designs



**NESC**



**ATESC**



**RLESC**

# (ELR) Electrical Latch Retraction



Our electrified latch pullback exit device allows for remote keyless access control in high occupancy/high traffic conditions where exit devices are required. Common applications include conditions such as hospitals, airports, schools, churches and they are commonly specified in applications that require automatic door openers. The device may be continuously energized allowing for a push/pull condition if desired.

## Features:

- Available on 9800 Series, including rim, vertical rod, concealed vertical rod, fire and non fire-rated devices.
- High-performance quality solenoids designed for demanding applications
- The PM200\* interface power module (included) is programmed to meet the requirements of the specific exit device modification. It maximizes the efficiency and life of the solenoid, allows for a much longer wire run and may be used with 24VDC power supplies rated at 1.5A or greater
- Dual coil solenoids, or PWM programming, allow for either momentary or extended time latch retraction
- No hassle 3-Year Warranty

## Specifications

- Voltage – 24VDC
- Amperage – Surge current – 12A for 200ms@24V / Holding – 250mA@24V
- Coil resistance – 3.7Ω

## To order, specify:

- Prefix **ELR** before PART#

# Signal Switch RX and LX

**RX** (request to exit) signal switch is used to signal the use of an opening from the push side. When the push pad is Depressed, the switch is activated. These devices are equipped with an internal SPDT (single pole double throw) switch that monitors the touch bar.

**LX** (latch bolt monitoring) signal switch monitors both egress and access of an opening. When the latch bolt is retracted, the switch is activated. These devices are equipped with an internal SPDT (single pole double throw) switch that monitors the latch bolt position.

**LX** and **RX** switches can be combined.

**LX**, **RX** switches can be used in combination with **EL** (electric latch retraction) option.

## Specifications

**RX** or **LX**.....Switch rated 0.5 amps @ 24VAC/DC resistive  
Low current **RX** or **LX**.Switch rated 0.5 amps @ 24VAC/DC resistive  
For Factory Installed:

## To Order, Specify:

Prefix: - **RX**.....Request to Exit switch for field installation  
          **LX**.....Latch Bolt Monitoring switch for field installation  
          **LXRX**.....Latch Bolt Monitoring / Request to Exit Combination

# Heavyduty Keyless Locks



## MECHANICAL CRCODE101

### Features

- **For use with Rim & Vertical Exit Devices**
- Heavy Duty
- Designed for 7700 and 9800 Series
- Grade 1 Panic Exit Device
- Single code (up to 8000 code combinations)
- Weather-resistant finish
- Code can be changed anytime without dismounting
- Full size, non-handed lever handle
- Easy Installation
- Reversible Handing

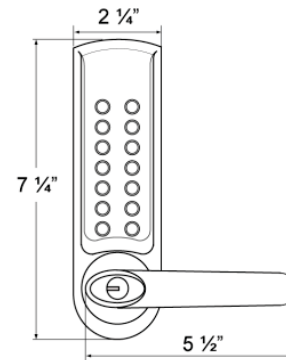

## ELECTRONIC CRCODE007

### Features

- **For use with Rim Exit Devices only**
- Dual mode for code free entry either mechanically by key or electronically thru the keypad
- Designed for 7700 and 9800 Series
- Can store up to 90 different numeric user codes in 4, 5 or 6 digits
- Settings remain in memory when batteries are removed
- Audible alarm sounds after 3 incorrect attempts
- Connections available for remote release switch and automatic lock activation when linked to Fire alarm system
- Can be used as STOREROOM or CLASSROOM function
- Factory default set as STOREROOM function
- Fast and easy programming via master code

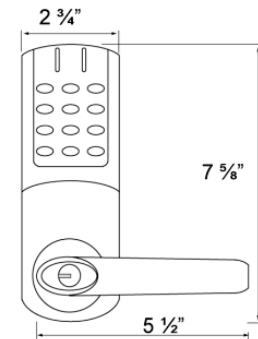

## CR5000 TRILOGY® KEYLESS EXIT TRIM

### Features

- **For use with Rim Exit Devices only**
- Clutch mechanism insures long life and durability
- Fingertip and/or Windows Programmable
- 2000 User Codes: Master, manager, supervisor and users
- Real Time Clock for up to 40,000 Event Time/Date-Stamped Audit Trail
- Up to 500 Lock/Unlock Schedules (with Time Zone Support)
- Rugged 12-Button Metal Keypad
- Non-Handed; Fully Field Reversible
- Adaptable to most major manufacturers of standard RIM and IC RIM Cylinders
- Battery operated; uses 5 AA batteries



Optional Interchangeable Core available with Best, Falcon, Arrow Small Format and Schlage Full Size Format IC Cores

## KABA® - Cal-Royal Combination

Cal-Royal's Exit hardware devices combined with Kaba InSync CP provide a variety of alternatives when addressing community access control. Recommended for applications such as controlling building entry openings, common area rooms and doors with exit devices. InSync CP are available as stand-alone battery operated door locks designed to work in conjunction with Cal-Royal's Exit Hardware Devices.

For inquiries and information on InSync line of products please visit [www.kabamultihousing.com](http://www.kabamultihousing.com)



**CAL ROYAL**  
PRODUCTS, INC.



# POWER SUPPLIES FOR ELECTRIFIED EXIT DEVICES



The CRPS1N is a heavy duty, high quality, low cost solution for powering a single latch retracting exit device. The solid state design insures years of trouble-free operation. The power supply delivers raw, unregulated DC current which is ideal for the extreme in-rush requirement of most solenoid driven electric latch retracting exit devices. The power supply comes housed in a sturdy, yet compact metal enclosure.

## CRPS1N



### Features:

- Power supply delivers the necessary high current in-rush for a single exit device
- Solid-state design eliminates problems associated with mechanical relays
- Single input/output



### Specifications:

- Input voltage – 120 VAC
- Output voltage – 24 VDC unregulated @ 1A
- Temperature range – 0 to 120F
- 1 Solid-State input/output (input triggered by dry contact)
- LEDs – RED = Power indicator  
GREEN = Channel on
- Enclosure dimensions: 10" x 10" x 4"

The CRPS2 Series power supplies are high quality, cost effective solution for powering two electric latch-retracting exit devices. These power supplies provide the necessary surge current that most latch-retracting exit devices require. The CRPS2 Series offers features found on power supplies costing much more; and the solid-state design and careful attention to detail make the CRPS2 Series ideal choice for the discerning user who requires a power supply that can offer years of trouble-free operation.

## CRPS2 CRPS2BB



### Features:

- Delivers the necessary in-rush current to power two latch pullback exit devices.
- Two independent inputs/outputs
- Solid-state design eliminates mechanical problems associated with relays
- Thermal overload sensing reduces risk of failure due to overheating
- Fire alarm disconnect link
- Inputs triggered by dry contact
- Intelligent short circuit detection detects shorts much faster than fuses and isolates the short to the individual output
- Removable Euro-style terminal blocks allow for easy installation
- UL Pending at time of print
- No hassle 3-Year Warranty

### Additional Features (CRPS2BB Only):

- Efficient battery backup/charging circuitry with zero voltage drop at power loss
- Solid state reverse polarity protection for battery connections
- Audible alert when sensing AC power failure & low battery (batteries not included)
- Output Voltage – 24 VDC unregulated @ 2.3A
- Enclosure dimensions: 12.5" x 15" x 4"

### Specifications:

- Input Voltage – 120 VAC
- Output Voltage – 24 VDC unregulated @ 2A\*\*
- Temperature Range – 0 to 120 F
- 1 Solid-State input/output (input triggered by dry contact)
- LEDs – Red = Power indicator  
GREEN = Channel on
- Enclosure dimensions: 10" x 10" x 4" \*\*

\*\*CRPS2 only

The CRSW3 power supply is a low cost, regulated switching power supply. It is designed specifically to supply power to low current DC devices such as mortise locks, cylindrical locks and electric strikes. The CRSW3 supplies 2.4A @ 27VDC and provides (3) non-fused outputs. The CRSW3 comes housed in a 10" x 10" x 4" sturdy metal enclosure.

## CRSW3



### Features:

- Adjustable output voltage (22-27V under load)
- No hassle 3-Year Warranty

### Specifications:

- Input voltage – 110 or 240VAC
- Output voltage – 2.4A @ 27VDC
- (3) Non-fused outputs
- Enclosure dimensions : 10" x 10" x 4"



# MCVR9800 & FMCVR9800 Series

## Optional Less Bottom Rod (LBR)

### Grade 1 Concealed Vertical Rod Exit Device For Metal Doors



3 HOUR FIRE RATED  
UL10C, UBC7-2-1997

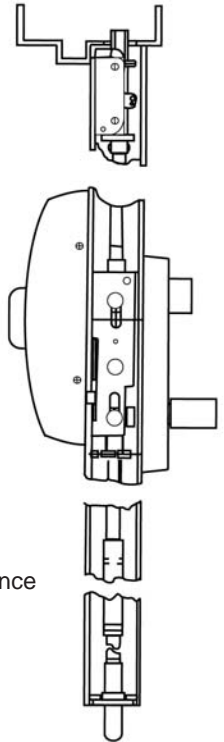

#### Specifications

<b>LBR (Optional)</b> .....	No Bottom Strike. Free access for wheel chairs, stretchers and carts which eliminates tripping potential and disfiguration of floors due to dragging of bottom bolts.
<b>For Doors</b> .....	Metal. 1 3/4" (44.5mm) minimum thickness 4 1/2" (114mm) minimum stile width
<b>Chassis</b> .....	Nonferrous alloy (Panic Grade), steel (Fire Grade)
<b>Chassis Cover</b> .....	Bronze or stainless steel
<b>Mounting</b> .....	Furnished standard with machine screws
<b>End Cap</b> .....	Brass, Bronze or Stainless Steel construction
<b>Hand</b> .....	Handed. Easily field reversible. Specify at time of order LHR, RHR for convenience
<b>ANSI Standard</b> .....	A156.3, Grade 1
<b>Strikes</b> .....	260 top and 265 bottom
<b>Top and Bottom Bolts</b> .....	Stainless Steel . Top and bottom bolt travel 7/16" (11mm) Projection adjustable up to 1" (25mm)
<b>Fire Exit Hardware</b> .....	FMCVR9800 Series for fire exit hardware for all types of 8' x 8' Double doors for up to 3 hour fire labeled installations, conforms to standards UL10C and UBC 7-2-1997 codes
<b>Rail Height</b> .....	Specify door opening and mounting height of center line of rail when ordering a Vertical Rod Exit Device 41" from floor
<b>Trim</b> .....	See Trim Designs section
<b>Electronic Functions</b> .....	(ELR) Electrical Latch Retraction and RX & LX Signal Switch available
<b>Alarm</b> .....	Prefix "NALRM" before PART#
<b>Dogging Feature</b> .....	Cylinder dogging available for non-rated applications

MODEL SIZE	ACTUAL LENGTH	MAXIMUM CUT DOWN	DOOR SIZE
M98CVR3684 and M98CVR3696	32"	6"	30" to 36" door width

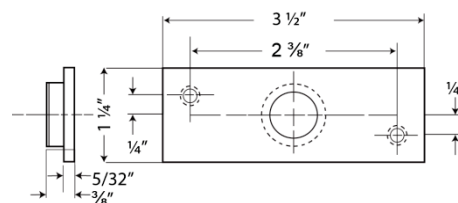

260 TOP STRIKE

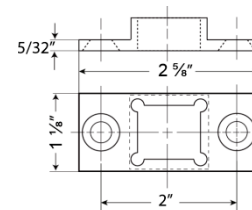

265 BOTTOM STRIKE

- For applications metal frames
- Stainless Steel

- Furnished with expansion shields
- Mortised into floor
- Stainless Steel

# WCVR9800 & FWCVR9800 Series

## Optional Less Bottom Rod (LBR)

### Grade 1 Concealed Vertical Rod Exit Device For Wood Doors

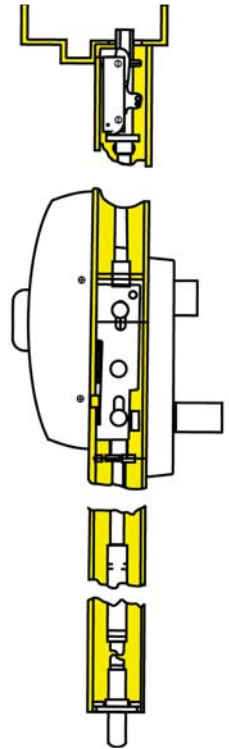

#### Specifications

<b>LBR (Optional)</b> .....	No Bottom Strike. Free access for wheel chairs, stretchers and carts which eliminates tripping potential and disfiguration of floors due to dragging of bottom bolts.
<b>For Doors</b> .....	Wood. 1 3/4" (44.5mm) minimum thickness 4 1/2" (114mm) minimum stile width
<b>Chassis</b> .....	Nonferrous alloy (Panic Grade), steel (Fire Grade)
<b>Chassis Cover</b> .....	Bronze or stainless steel
<b>Mounting</b> .....	Furnished standard with machine screws
<b>End Cap</b> .....	Brass, Bronze or Stainless Steel construction
<b>Hand</b> .....	Handed. Easily field reversible. Specify at time of order LHR, RHR for convenience
<b>ANSI Standard</b> .....	A156.3, Grade 1
<b>Strikes</b> .....	260 top and 265 bottom
<b>Top and Bottom Bolts</b> .....	Stainless Steel. Top and bottom bolt travel 7/16" (11mm) Projection adjustable up to 1" (25mm)
<b>Fire Exit Hardware</b> .....	FWCVR9800 Series for fire exit hardware for all types of 8' x 8' Double doors for up to 3 hour fire labeled installations, conforms to standards UL10C and UBC 7-2-1997 codes
<b>Rail Height</b> .....	Specify door opening and mounting height of center line of rail when ordering a Vertical Rod Exit Device 41" from floor
<b>Trim</b> .....	See Trim Designs section
<b>Electronic Functions</b> .....	(ELR) Electrical Latch Retraction and RX & LX Signal Switch available
<b>Alarm</b> .....	Prefix "NALRM" before PART#
<b>Dogging Feature</b> .....	Cylinder dogging available for non-rated applications

MODEL SIZE	ACTUAL LENGTH	MAXIMUM CUT DOWN	DOOR SIZE
W98CVR3684 and W98CVR3696	32"	6"	30" to 36" door width

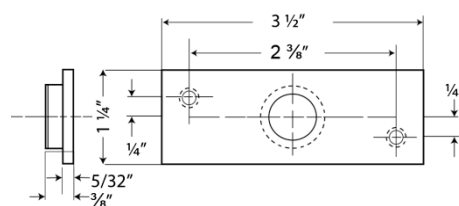

260 TOP STRIKE

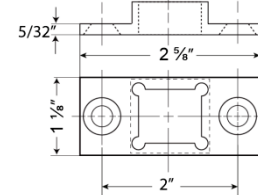

265 BOTTOM STRIKE

- For applications metal frames
- Stainless Steel
- Furnished with expansion shields
- Mortised into floor
- Stainless Steel

# MCVR9800, FMCVR9800, WCVR9800 & FWCVR9800 Concealed Vertical Rod Exit Device For Wood And Metal Doors Trim Selection



## ESCUTCHEON LEVER DESIGN

### CONSTRUCTION

- Free-wheeling clutch mechanism
- Grade 1, thru-bolted design
- Non-handed design. Easily field reversible.
- Hardened steel heavy duty tailpiece available for fire and non-fire rated rim and concealed vertical rod exit devices.

### FINISHES

Architectural plated finishes

### DOOR THICKNESS

Standard 1  $\frac{3}{4}$ "

### ESCUTCHEON DIMENSIONS

2  $\frac{5}{16}$ " width X 8  $\frac{1}{2}$ " length. Lever length: 4  $\frac{3}{4}$ ".  
Fits and covers 2  $\frac{1}{8}$ " 161 cutout



#### ELECTRIFICATION NOT AVAILABLE FOR TRIM.

Electrical Lath Retraction (ELR), Request to Exit (RX) and Latchbolt Monitoring (LX) available for Exit Device only.

**CVRESC9800 or**  
**ICCVRESC9800 or**  
**ICSCCVRESC9800** **ENTRANCE**  
Clutch Entrance, key locks or unlocks escutcheon trim  
ANSI FUNCTION (63) Operates as classroom function

**CVRESC9805 or**  
**ICCVRESC9805 or**  
**ICSCCVRESC9805** **STOREROOM**  
Clutch Storeroom, key unlocks lever, lever retracts latch  
bolt, otherwise always locked  
ANSI FUNCTION (04)

**CVRESC9830** **PASSAGE**  
Trim always operable and free  
ANSI FUNCTION (62)

**CVRESC9840** **DUMMY**  
Dummy Escutcheon trim ANSI FUNCTION (10)

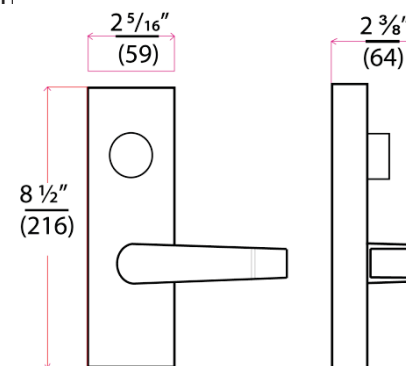

**KEYWAY:** 6 pin solid brass "C" keyway Mortise Cylinder standard. Optional: Schlage E, Schlage C-K, Russwin D1-2-3-4, Corbin 59/60, Sargent LA-LB-LC, Falcon/Weiser E, Arrow A, Yale 8, Yale GA and Kwikset. Can also accept Medeco, Assa and Kaba High Security Cylinders.

# MR9800 and FMR9800 Series



## Grade 1 Mortise Lock Exit Device

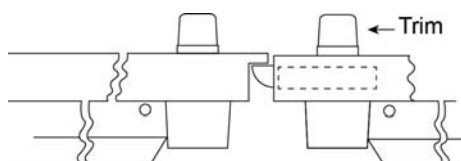

Pair of Doors

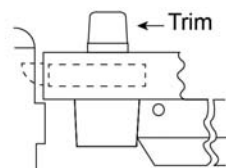

Single Door

### Specifications

<b>For Doors.....</b>	Wood/Metal 1 3/4" (44.5mm) minimum thickness 4 1/2" (114mm) minimum stile width
<b>Chassis.....</b>	Nonferrous alloy (Panic Grade), steel (Fire Grade)
<b>Chassis Cover.....</b>	Bronze or stainless steel
<b>Mounting.....</b>	Furnished standard with wood and machine screws
<b>End Cap.....</b>	Brass, Bronze or Stainless Steel construction
<b>Handing.....</b>	Handed. Reversible. Specify RHR or LHR for convenience
<b>ANSI Standard.....</b>	A156.3, Grade 1
<b>Strikes.....</b>	Standard ANSI strike
<b>Fire Exit Hardware.....</b>	FMR9800 Series for fire exit hardware for all types of 8' x 8' double doors for up to 3 hour fire labeled installations, conforms to standards UL10C and UBC 7-2-1997 codes
<b>Mortise Lock.....</b>	Grade (1) for 1 3/4" (44.5mm) thick doors. Reversible. Fits door prepared for ANSI Standard A115.1
<b>Trim.....</b>	See Trim Designs section
<b>Electronic Functions.....</b>	(ELR) Electrical Latch Retraction and RX & LX Signal Switch available
<b>Alarm.....</b>	Prefix "NALRM" before PART#
<b>Dogging Feature.....</b>	Cylinder dogging available for non-fire rated applications

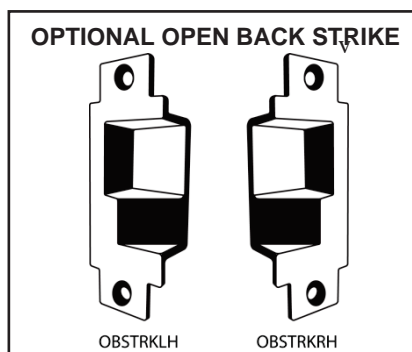

MODEL SIZE	ACTUAL LENGTH	MAXIMUM CUT DOWN	DOOR SIZE
MR9800EO36, FMR98EO36	32"	6"	30" to 36" door width
MR9800EO48, FMR98EO48	44"	12"	36" to 48" door width



# MR9800 and FMR9800

## Grade 1 Mortise Lock Exit Device

# Trim Selection

## ESCUTCHEON LEVER DESIGN

### CONSTRUCTION

- Refer to Mortise Lock NM Series for product information

### FINISHES

Architectural plated finishes

### DOOR THICKNESS

Standard 1 3/4"

### ESCUTCHEON DIMENSIONS

2" width X 8 1/2" length. Lever length: 4 3/4".

Fits and covers 2 1/8" 161 cutout

**IMPORTANT: MR7700 and FMR7700 Trims come standard with exit device.**



- MRESC9800 or**
- ICMRESC9800 or**
- ICSCMRESC9800**

### ENTRANCE

Key locks or unlocks lever  
Operates as classroom function  
ANSI FUNCTION (63)

- MRESC9805 or**
- ICMRESC9805 or**
- ICSCMRESC9805**

### STOREROOM

Key retracts latch bolt, otherwise always locked  
ANSI FUNCTION (04)  
\*MUST USE MR98005EO36/48 Mortise Rim Exit

### MRESC9830

### PASSAGE

Trim always operable and free  
ANSI FUNCTION (62)  
\*MUST USE MR98005EO36/48 Mortise Rim Exit

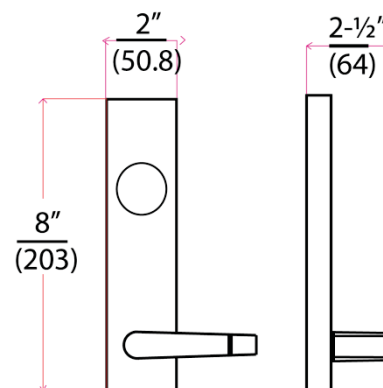

**KEYWAY:** 6 pin solid brass "C" keyway Mortise Cylinder standard. Optional: Schlage E, Schlage C-K, Russwin D1-2-3-4, Corbin 59/60, Sargent LA-LB-LC, Falcon/Weiser E, Arrow A, Yale 8, Yale GA and Kwikset. Can also accept Medeco, Assa and Kaba High Security Cylinders.

- (IC) INTERCHANGEABLE CORE:** Interchangeable Core locks will accept compatible 6 or 7 pin cores with BEST, FALCON and ARROW.

- (ICSC) INTERCHANGEABLE CORE:** Indicates function available with Schlage Full size format Interchangeable Core.

**FOR ELECTRIFICATION OPTION:  
SPECIFY ITEM# UPON ORDERING**

(MORTISE TRIM COMES STANDARD WITH EXIT DEVICE)

ITEM#	DESCRIPTION
FS12 MR98	<b>FS12</b> FAIL-SAFE OPTION 12V AC/DC
FS24 MR98	<b>FS24</b> FAIL-SAFE OPTION 24V AC/DC
FSE12 MR98	<b>FSE12</b> FAIL-SECURE OPTION 12V AC/DC
FSE24 MR98	<b>FSE24</b> FAIL-SECURE OPTION 24V AC/DC

# GLS9800 Series

## Grade 1 Rim Type, Narrow Stile Exit Device



### Specifications

<b>For Doors.....</b>	Wood, Metal or Aluminum Glass doors with 1 3/4" minimum stile width, 1 3/4" thickness for single or double door application
<b>Chassis.....</b>	Non-ferrous alloy (Panic Grade)
<b>Cover.....</b>	Brass, Bronze or Stainless Steel construction
<b>Mounting.....</b>	Furnished with wood and machine screws. Thrubolts available upon request
<b>End Cap.....</b>	Brass, Bronze or Stainless Steel construction

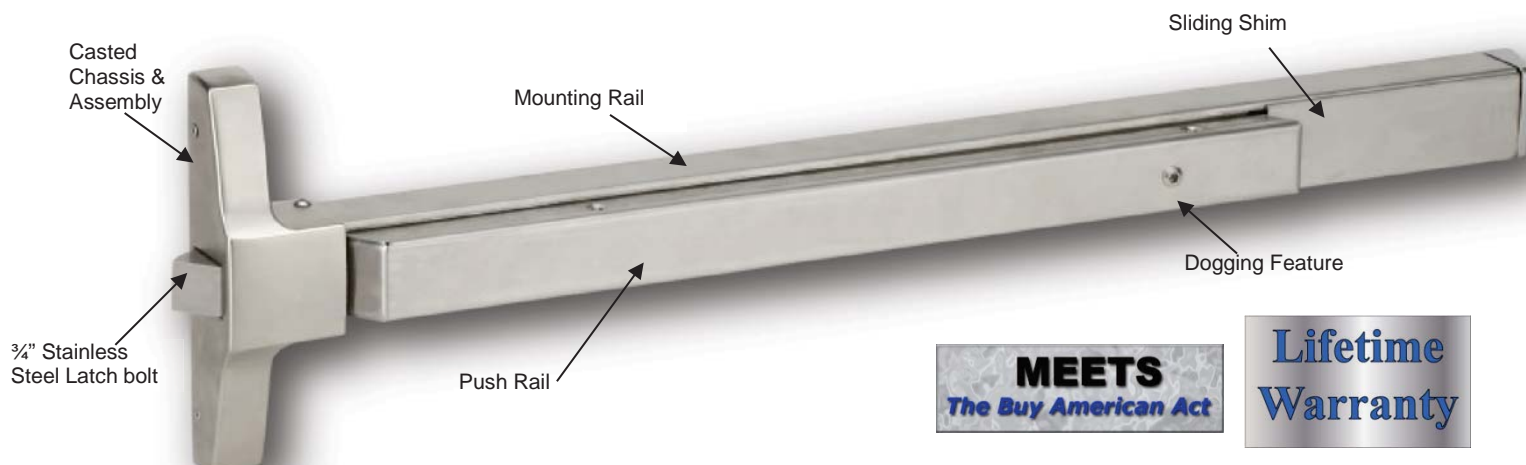

<b>Alarm.....</b>	Available. Prefix NALRM before PART# (for 36" door size only)
<b>Hand.....</b>	Non-handed
<b>Latch Bolt.....</b>	Stainless steel 3/4" throw
<b>Spring.....</b>	Stainless steel throughout
<b>ANSI Standard.....</b>	A156.3, Grade 1
<b>Rail Assembly.....</b>	Heavy gauge brass, Bronze or Stainless Steel
<b>Strike.....</b>	246 packed standard. Optional 247 strike. (See strike page)
<b>Dogging Feature.....</b>	Allen-type key furnished standard
<b>Mullion.....</b>	Available
<b>UL and ULC Listed.....</b>	GLS9800 Series for Panic and Safety for all types of 4' x 8' single doors and 8' x 8' double doors
<b>Finish.....</b>	Architectural plated finishes
<b>Electronic Functions.....</b>	(ELR) Electrical Latch Retraction and RX & LX Signal Switch available

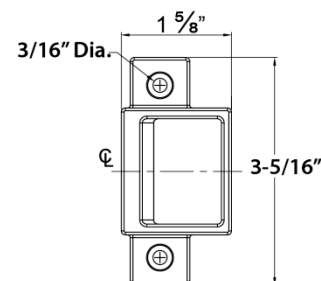

**246 STRIKE**

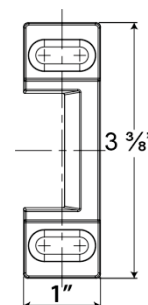

**247 STRIKE (OPTIONAL)**

### DIMENSIONS

Push Rail height to finished floor	41" (1034mm) at center		
Push Rail Projection			
Neutral	2 ½" (63.5mm)		
Depressed	1 ⅞" (47.625mm)		
Center case	8 ⅙" x 1 ⅛" x 2" (205mm x 27.575mm x 50.8mm)		
MODEL	ACTUAL LENGTH	MAX CUT DOWN	DOOR SIZE
GLS9800EO36	34 17/32"	6"	30" to 36" width
GLS9800EO48	46 11/32"	18"	30" to 48" width

# GLSCVR9800 Series

## Grade 1 Concealed Vertical Rod Type, Narrow Stile Exit Device Optional Less Bottom Rod (LBR)



### Specifications

<b>For Doors.....</b>	Metal or Aluminum Glass doors with 1 3/4" minimum stile width, 1 3/4" thickness for single or double door application
<b>Chassis.....</b>	Non-ferrous alloy (Panic Grade)
<b>Cover.....</b>	Brass, Bronze or Stainless Steel construction
<b>Mounting.....</b>	Furnished with wood and machine screws
<b>End Cap.....</b>	Brass, Bronze or Stainless Steel construction

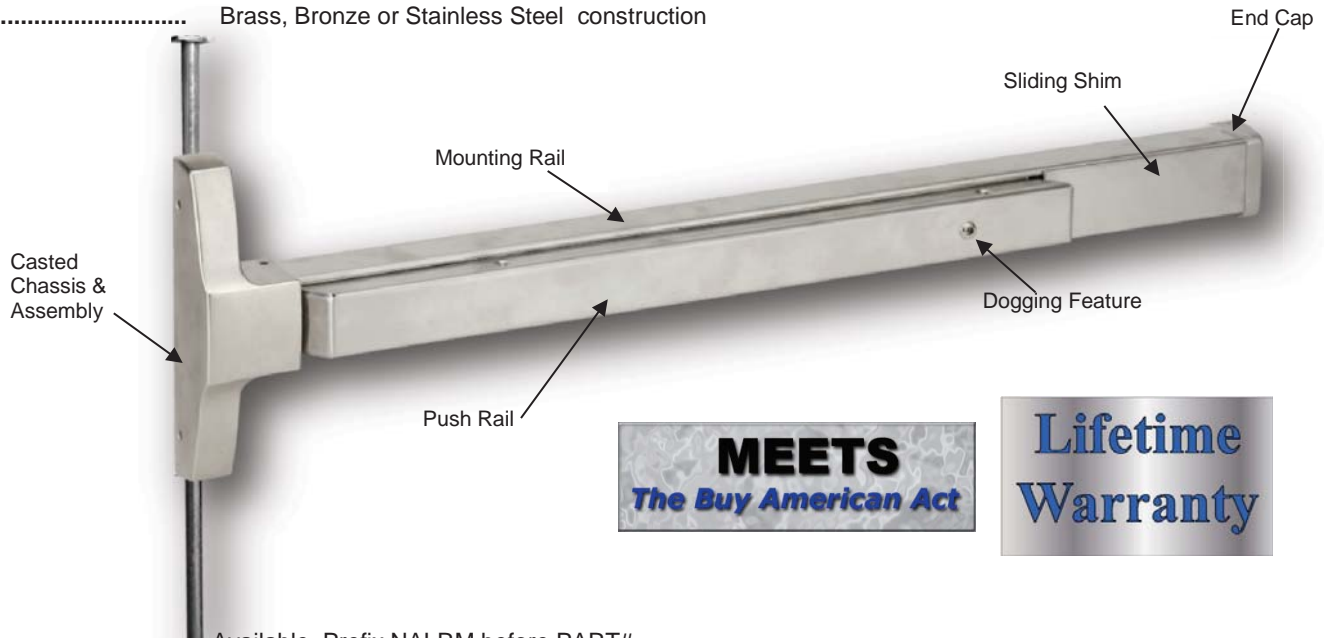

<b>Alarm.....</b>	Available. Prefix NALRM before PART#
<b>Hand.....</b>	Handed. Specify RHR or LHR
<b>Top and Bottom Bolts.....</b>	Stainless steel. Top and bottom bolt travel 7/16" (11mm) Projection adjustable to 1" (25mm)
<b>Spring.....</b>	Stainless steel throughout
<b>ANSI Standard.....</b>	A156.3, Grade 1
<b>Rail Assembly.....</b>	Heavy gauge brass, Bronze or Stainless Steel
<b>Strike.....</b>	260 Top and 265 Bottom strikes packed standard (See strike page)
<b>Dogging Feature.....</b>	Allen-type key furnished standard
<b>Mullion.....</b>	Available
<b>UL and ULC Listed.....</b>	GLSCVR9800 Series for Panic and Safety for all types of 4' x 8' single doors and 8' x 8' double doors for Panic & Safety
<b>Finish.....</b>	Architectural plated finishes
<b>Electronic Functions.....</b>	(ELR) Electrical Latch Retraction and RX & LX Signal Switch available

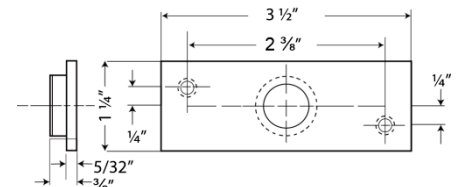

**260 TOP STRIKE**

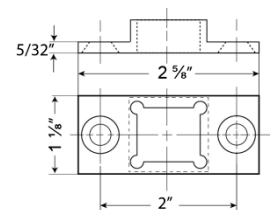

**265 BOTTOM STRIKE**

Push Rail height to finished floor	41" (1034mm) at center		
Push Rail Projection			
Neutral	2 ½" (63.5mm)		
Depressed	1 ⅞" (47.625mm)		
Center case	8 ⅛" x 1 ⅛" x 2"(205mm x 27.575mm x 50.8mm)		
<b>MODEL</b>	<b>ACTUAL LENGTH</b>	<b>MAX CUT DOWN</b>	<b>DOOR SIZE</b>
GLSCVR9800EO36	34 <sup>17</sup> / <sub>32</sub> "	6"	30" to 36" width
GLSCVR9800EO48	46 <sup>11</sup> / <sub>32</sub> "	18"	30" to 48" width

# Trim Selection



## ESCUTCHEON LEVER DESIGN

### CONSTRUCTION

- Free-wheeling clutch mechanism.
- Grade 1, thru-bolted design. Reversible design.
- Hardened steel heavy duty tailpiece. Available for rim and concealed vertical rod exit devices.

### DOOR THICKNESS

Standard 1 3/4".

### ESCUTCHEON DIMENSIONS

1-13/16" width X 8" length

Lever length: 4 3/4"



**IMPORTANT:** GLS7700 and GLSCVR7700 Trims are interchangeable with GLS9800 and GLSCVR9800 Trims

**ELECTRIFICATION NOT AVAILABLE FOR TRIM.**  
Electrical Lath Retraction (ELR), Request to Exit (RX) and Latchbolt Monitoring (LX) available for Exit Device only.

- GLSRIM9800**
- GLSCVR9800**
- ICGLSRIM9800**
- ICSCGLSRIM9800**
- ICGLSCVR9800**
- ICSCGLSCVR9800**

### ENTRANCE

Clutch free-wheeling Entrance, key locks or unlocks escutcheon trim

ANSI FUNCTION (63) Operates as classroom function

CVR is used for Concealed Vertical Rod Exit Device  
RIM is used for Rim Type Exit Device

- GLSRIM9805**
- GLSCVR9805**
- ICGLSRIM9805**
- ICSCGLSRIM9805**
- ICGLSCVR9805**
- ICSCGLSCVR9805**

### STOREROOM

Clutch free-wheeling Storeroom, key unlocks lever, lever retracts latch bolt, otherwise always locked

ANSI FUNCTION (04)

CVR is used for Concealed Vertical Rod Exit Device  
RIM is used for Rim Type Exit Device

- GLSRIM9830**
- GLSCVR9830**

### PASSAGE

Trim always operable and free

ANSI FUNCTION (62)

CVR is used for Concealed Vertical Rod Exit Device  
RIM is used for Rim Type Exit Device

- GLSRIM9840**
- GLSCVR9840**

### DUMMY

Dummy Escutcheon trim ANSI FUNCTION (10)

CVR is used for Concealed Vertical Rod Exit Device  
RIM is used for Rim Type Exit Device

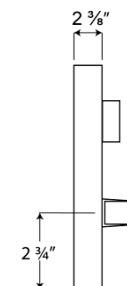
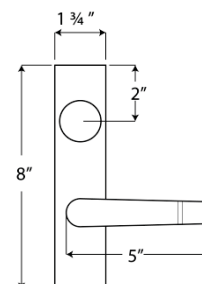

**KEYWAY:** 6 pin solid brass "C" keyway Mortise Cylinder standard. Optional: Schlage E, Schlage C-K, Russwin D1-2-3-4, Corbin 59/60, Sargent LA-LB-LC, Falcon/Weiser E, Arrow A, Yale 8, Yale GA and Kwikset. Can also accept Medeco, Assa and Kaba High Security Cylinders.

**(IC) INTERCHANGEABLE CORE:** Interchangeable Core locks will accept compatible 6 or 7 pin cores with BEST, FALCON and ARROW.

**(ICSC) INTERCHANGEABLE CORE:** Indicates function available with Schlage Full size format Interchangeable Core.



# Trim Selection



## PULL DESIGN – FOR GLS9800 RIM EXIT DEVICE ONLY

**98GLSNL**  
**IC98GLSNL**  
**ICSC98GLSNL**

Outside by pull and key.  
 Key retracts latch bolt.  
 ANSI function – 03  
**(SPECIFY HANDING)**

**98GLSUP**

Outside by pull only.  
 Pull when dogged.  
 ANSI function – 02  
**(NON-HANDED)**

**GLSRIMEOP**

Outside cover plate only.  
 ANSI function – 10

### KEYWAY

6 pin solid brass "C" keyway  
 Rim Cylinder standard.

### FINISHES

Architectural plated finishes.

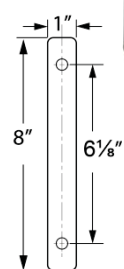
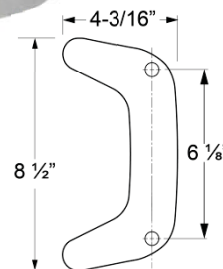
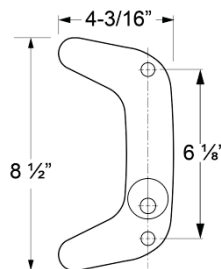

**IMPORTANT: GLS7700 and GLSCVR7700 Trims are interchangeable with GLS9800 and GLSCVR9800 Trims**



**98GLSCYL-1**



**IC98GLSCYL-1**  
**ICSC98GLSCYL-1**

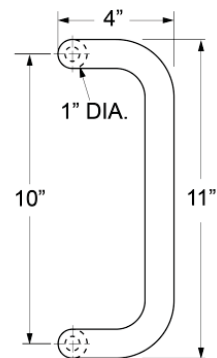

**OFSTPUL-10**  
**(REVERSIBLE)**

Outside by pull only

**KEYWAY:** 6 pin solid brass "C" keyway Mortise Cylinder standard. Optional: Schlage E, Schlage C-K, Russwin D1-2-3-4, Corbin 59/60, Sargent LA-LB-LC, Falcon/Weiser E, Arrow A, Yale 8, Yale GA and Kwikset. Can also accept Medeco, Assa and Kaba High Security Cylinders.

### **(IC) INTERCHANGEABLE CORE**

Interchangeable Core locks will accept compatible 6 or 7 pin cores with BEST, FALCON and ARROW.

**(ICSC) INTERCHANGEABLE CORE:** Indicates function available with Schlage Full size format Interchangeable Core.

# Strikes & Accessories

## Strikes for use with 9860 vertical rod exit device

All strikes are black nylon coated

### 221

Standard for 9860.  
Applied to surface of floor or to a flat threshold.  
Standard packaging.

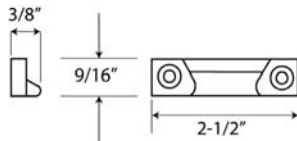

### 227

Applied to surface of stop.  
No mortise required.  
Standard packaging.

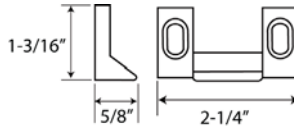

### 233

Bottom strike. Alternate bottom strike. Flush mounting stainless steel. Furnished with expansion shields. Requires mortise in the floor.

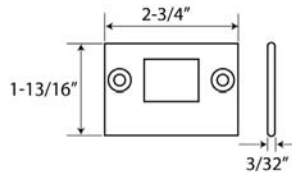

## Strikes for use with 9800 rim type exit device

### 239

For 9800 & F9800 surface applied.  
Standard packaging

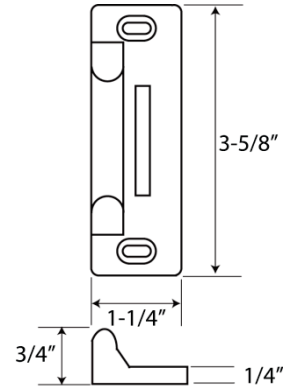

### RIM238

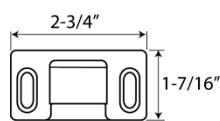

Strike for 2 3/8" Backset Application

## Strikes for FMCVR9800, MCVR9800, WCVR9800, FWCVR9800, GLSCVR9800 fire and non-fire exit device

### 260 TOP STRIKE

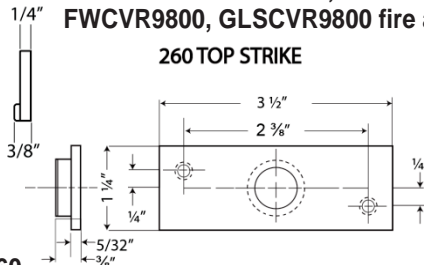

### 265 BOTTOM STRIKE

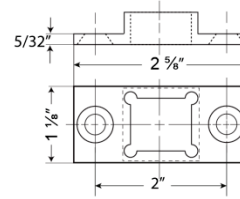

## Strikes for use with F9860 vertical rod fire rated exit device

### 245

Surface applied for F9860.  
Standard packaging.

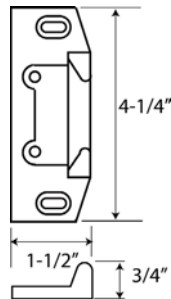

## Strikes for use with GLS9800 Narrow Stile Exit Device

### 246

Used on frames with blade stop or integral stop. Surfaced applied or mortised.  
Standard packaging.

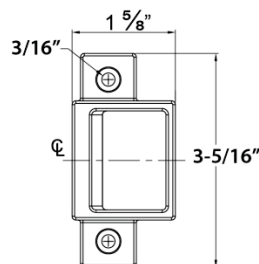

### 247

Applied to surface of stop.  
No mortise required.

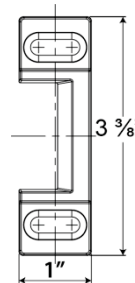

### 245

For F9800 surface applied.  
Standard packaging.

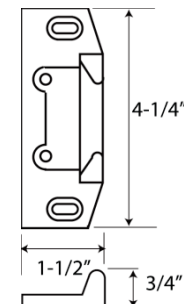

### 233

Bottom strike for F9860.  
Flush mounting stainless steel. Furnished with expansion shields. Requires mortise in the floor.  
Standard packaging.

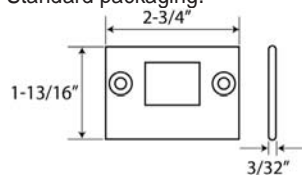

## Overlapping Strikes N251

Surface applied. Used on inactive leaf for device on active leaf of pair of doors without mullion

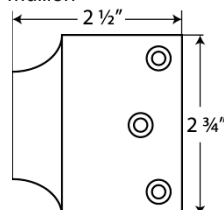

## Additional Accessories LFF

Lock front filler

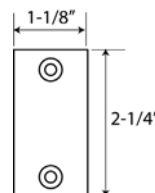

## SF

Strike filler

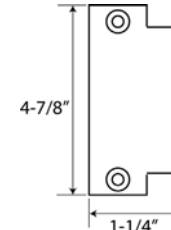

# Accessories



## MULLIONS

**418** – Removable mullion Aluminum painted (Prime coat) includes top and bottom retainer supplied as a stock 96" for non fire rated applications.

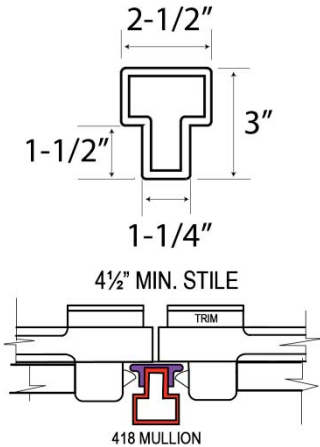

Electric lockable mullions are available on request.

### Additional Rods

Vertical Rods for 10 feet high doors available on non-fire rated vertical rod devices only. Use part# VRRD-10.

Concealed Vertical Rod for 96" Metal Door use  
Part # MCVROD96. For wood door use Part # WCVROD96.

**KEYWAYS:** 6 pin solid brass "C" keyway standard. Optional: Schlage E, Schlage C-K, Russwin D1-2-3-4, Corbin 59/60, Sargent LA-LB-LC, Falcon/Weiser E, Arrow A, Yale 8, Yale GA and Kwikset. Can also accept Medeco, Assa and Kaba High Security Cylinders.

### GLASS BEAD SHIM KITS

- 801 – For rim type, 1/8" thick
- 806 – For vertical type, 1/8" thick
- 812 – For fire rated type, 1/8" thick

When exit devices are used with shim kits with outside trim, spindle length, thumbpiece and thru bolt length must be increased accordingly.

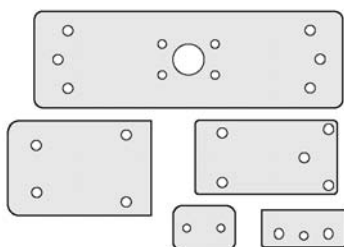

**LCK418** – Lockable Removable mullion Aluminum painted (Prime coat) includes top and bottom retainer supplied as a stock 96" for non fire rated applications.

**ICLCK418** - Interchangeable core locks will accept compatible 6 or 7 pin cores with BEST, FALCON and ARROW.

**ICSCCLK418** - Indicates function available with **Schlage Full size format** Interchangeable Core.

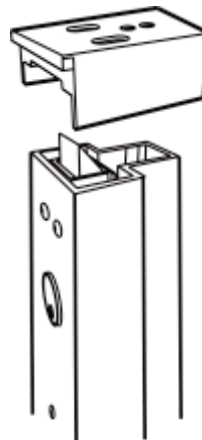

**424** – Fire exit mullion. 2" x 3" steel tubing round corner, iron construction with iron top and bottom retainers. To be used with two rim type devices on two independent active doors with full double door openings.

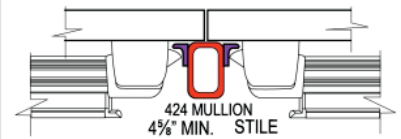

### CYLINDER DOGGING KITS

**TO ORDER:** Prefix "CD" before PART#. Available for all 9800 Series devices except fire exit hardware. Cylinder dogging with mortise cylinder is located on the mounting insert lock bolt in retracted position.

To order **KIT ONLY:** use PART# 36CD9800 for 36" and 48CD9800 for 48" devices. Specify finish.

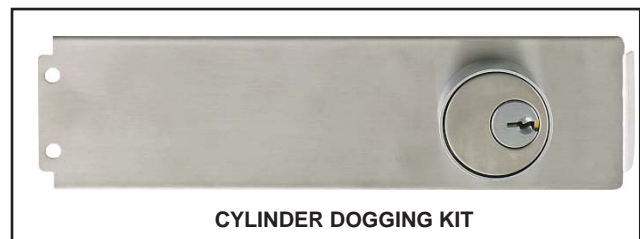

CYLINDER DOGGING KIT

# Fire Exit Hardware Selector



FIRE EXIT HARDWARE			UL DOOR RATING
APPLICATION	MODEL #	MAXIMUM DOOR OPENING	(A) 3 HOUR
<b>SINGLE DOORS</b> Rim type	F9800EO36 F9820EO48	4'0" X 8'0"	✓
<b>PAIRS OF DOORS</b> Two surface mounted standard vertical rod type or less bottom rod (LBR) application. Prefix <b>LBR</b> before Part#  a) Swinging in same direction b) Swinging in opposite direction ( double egress )	F9860V3684 X F9860V3684	8'0" X 7'2"	✓
	F9890V3696 X F9890V3696 F9880V4896 X F9880V4896	8'0" X 8'0"	✓
<b>PAIRS OF DOORS</b> Two rim type with Mullion	F9800EO36 F9820EO48	8'0" X 8'0"	✓

All fire rated exit devices in all applications, are also labeled for (B) 1 ½ hour, (C) ¾ hour, (D) 1 hour, (E) ¾ hour.  
All fire exit hardware meet UL10C and UBC 7-2-1997 codes.

## HOW TO ORDER INFORMATION

### Exit device model number

#### Panic grade

9800 EO36 Rim type 36" door  
9820 EO48 Rim type 48" door  
9860 V3684 Vertical rod type 36" x 84"  
9890 V3696 Vertical rod type 36" x 96"  
9880 V4896 Vertical rod type 48" x 96"  
VRRD10 – Rod for 10' non-rated door  
9850 V36120 Vertical rod type 36" x 120"  
9840 V48120 Vertical rod type 48" x 120"

#### Fire grade

F9800 EO36 Rim type 36" door  
F9820 EO48 Rim type 48" door  
F9860 V3684 Vertical rod type 36" x 84"  
F9890 V3696 Vertical rod type 36" x 96"  
F9880 V4896 Vertical rod type 48" x 96"

- 1) Specify exit device model number according to size of door.
- 2) Specify trim selection. For interchangeable core prefix "IC" before part #. See trim selection pages.
- 3) For vertical rod devices specify LHR (Left Hand Reverse ) or RHR ( Right Hand Reverse ) for convenience easily field reversible, otherwise shipped as LHR.
- 4) Specify finish:  
US3, 4, 10, 10B, 26D, 32D. See Page 33
- 5) On thru bolt applications, fire rated vertical rod devices are packed with thru bolts as standard feature.  
Thru bolts are also available for other devices. To order thru bolts add "SBN" to trim pack.

When ordering separately use following part#

Cal-Royal Part # 357 — Thru bolts for rim devices, 6 PCs / pack.  
Cal-Royal Part # 369 — Thru bolts for vertical rod devices, 14 PCs / pack.  
Cal-Royal Part # 363 — Thru bolts for rim devices, 6 PCs / pack for 2 ¼" thick doors.  
Cal-Royal Part # 375 — Thru bolts for vertical rod devices, 14 PCs / pack for 2 ¼" thick doors.

**Ordering example:** 9800EO36 ALUM X SBN X ENT00L 26D  
F9880V4896 10B X ICSTR05L 10B



# 9800 & F9800 Rim Type and Fire Exit Devices 9860 & F9860 Vertical Rod and Fire Exit Devices ANSI A156.3 Grade 1

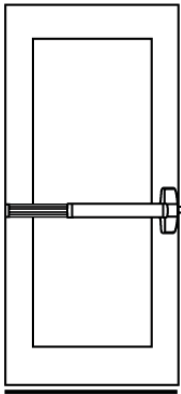
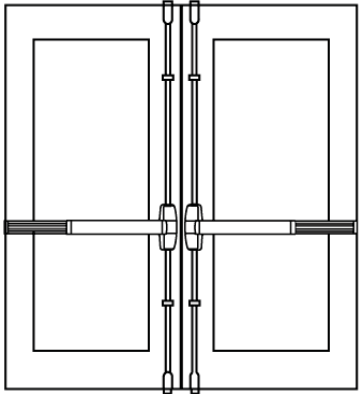
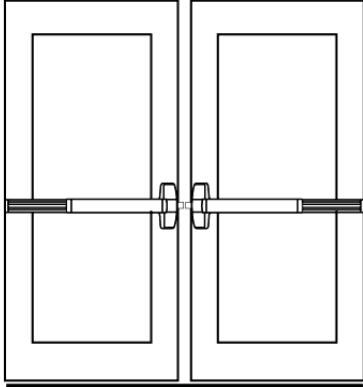
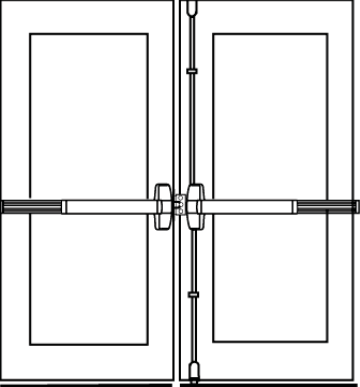
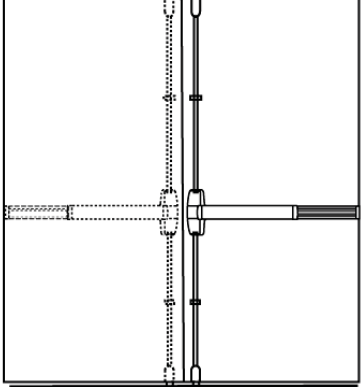
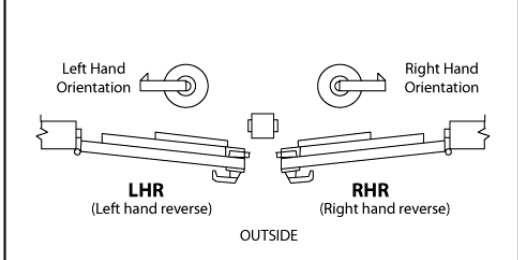

## SELECTOR CHART

<p><b>SINGLE DOOR</b></p>  <p><b>Vertical rod type or Rim type</b> Surface applied 2 point lock. Surface application.</p>	<p><b>PAIR OF DOORS WITHOUT MULLION</b></p>  <p><b>2 Vertical rod type</b> Surface applied 2 point locking both doors. Each door active same direction. Do not use with overlapping astragal.</p>
<p><b>PAIR OF DOORS WITH MULLION</b></p>  <p><b>2 Rim type with mullion</b> Two independent active doors with full double door openings when required. Same direction.</p>	<p><b>PAIR OF DOORS WITHOUT MULLION</b></p>  <p><b>1 Vertical rod and 1 rim type</b> Both devices are surface applied. A coordinator and overlapping strike is recommended.</p>
<p><b>PAIR OF DOORS WITHOUT MULLION</b></p>  <p><b>2 Vertical rod type</b> Double egress surface applied. 2 point locking both doors opposite directions.</p>	<p><b>HANDING</b></p>  <p><b>LHR</b> (Left hand reverse) <b>RHR</b> (Right hand reverse) OUTSIDE</p> <p><b>CAL-ROYAL PRODUCTS, INC.</b> 6605 FLOTILLA ST., COMMERCE, CA 90040 U.S.A. TEL: (323) 888-6601 FAX: (323) 888-6699 Website: <a href="http://cal-royal.com">cal-royal.com</a> * Email: <a href="mailto:sales@cal-royal.com">sales@cal-royal.com</a></p>

## EXIT DEVICES COMPARISON CHART

RIM EXIT DEVICE CONVERSIONS	RIM	VERTICAL ROD	RIM	VERTICAL ROD	CONCEALED VERTICAL ROD	MORTISE RIM	NARROW STILE RIM	NARROW STILE CVR
ARROW	S1200	S1100	S3800/ 1800	S3700	S3600	S3900	S4803	S4601
CAL-ROYAL	9800/ 7700	9860/ 7760	2200/ 4400	2260	MCVR9800/ WCVR9800/ MCVR7700/ WCVR7700	MR9800/ MR7700	GLS9800/ GLS7700	GLSCVR9800/ GLSCVR7700
CORBIN/RUSSWIN	ED8200	ED8400	ED5400/ ED6000	ED4750	ED5800	ED5600	ED4200	ED4800
DETEX	V4000	---	10	20	70	30	V40NS	60
DORMA	8300	8400	9300	9400	9100	9500	AD4300	AD4100
PRECISION	5100	5200	2100/ 100	9800/ 200	2800	2300	2400	2600
SARGENT	2828	2727	8800/ 9898	8700	MD8600/ WD8600	8900	AD8500	AD8410
VON DUPRIN	98/ 99	9827/ 9927	98	9827	9947EO	9975EO	33A	3348
YALE	2100	2110	7100/ 1500	7110/ 1510	7120	7130	7250	7220



Distributed by: